

Litter Champ[®]

Refill Installation

Instructions

- 1 Using both hands, hold the canister and press the Front Button to release the Top Frame

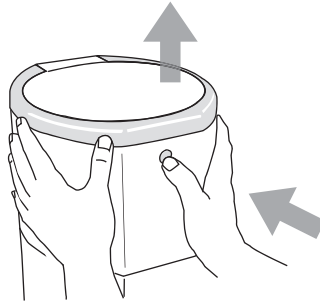

- 2 Lift out empty refill cartridge.

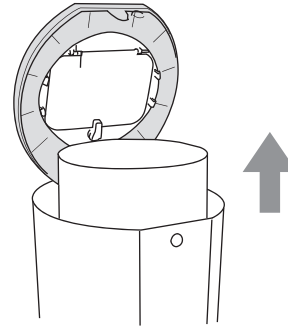

- 3 Slide new refill over empty cartridge.

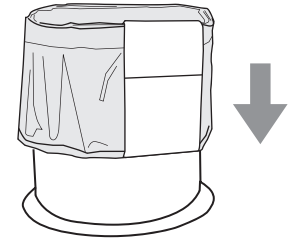

- 4 Remove the paper band and pull up OUTER LAYER of the refill.

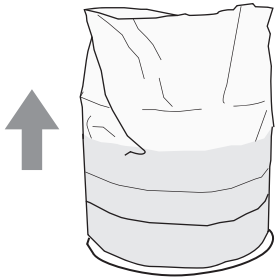

- 5 Push refill down through the middle of the cartridge.

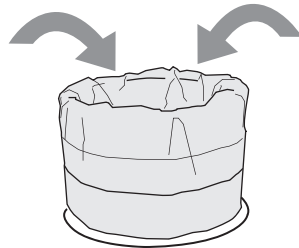

- 6 Replace the cartridge, with the newly installed refill.

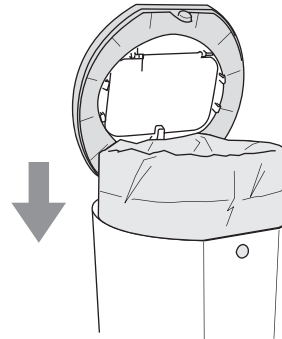

- 7 Pull refill down and tie a knot.

